

Double A
Hydraulics



®

series RVCP relief valve



536 TOWNSHIP LINE ROAD
FLUID TECHNOLOGY ANNEX
BLUE BELL, PENNSYLVANIA 19422
Tel: 215.643.0617
Fax: 216.643.4017
sales@doubleahydraulics.com
www.doubleahydraulics.com

6100 psi, 30 Gpm max
pilot operated spool type

TECHNICAL DATA

Maximum operating pressure 6100 psi
 Maximum Flow: 30 gpm
 Maximum leakage: 6 in³/min at 90% of setting
 Operating Temperature Range: -22F to 230F
 Viscosity: 60-1800 SSU hydraulic oil with lubricating properties
 Orientation: Optional
 Installation Torque: 40-45 foot pounds
 Weight: 0.43 pounds
 Pressure on port 2 (tank port) is directly additive to the valve setting at a 1:1 ratio.
 Steel construction
 Zinc Plated

PRESSURE DROP DATA

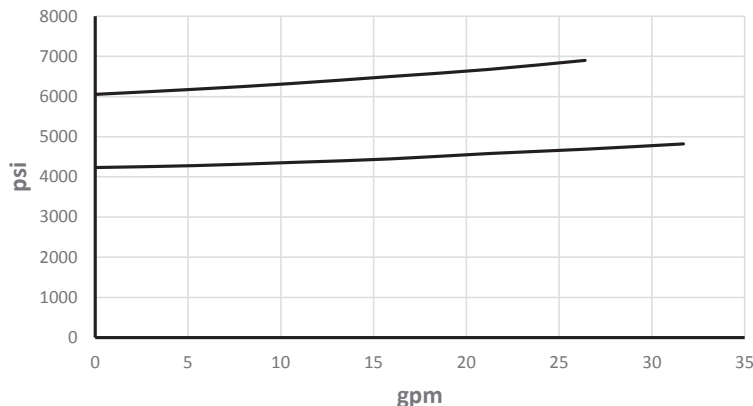

(Note: Curves shown at maximum setting for each spring)

DIMENSIONS

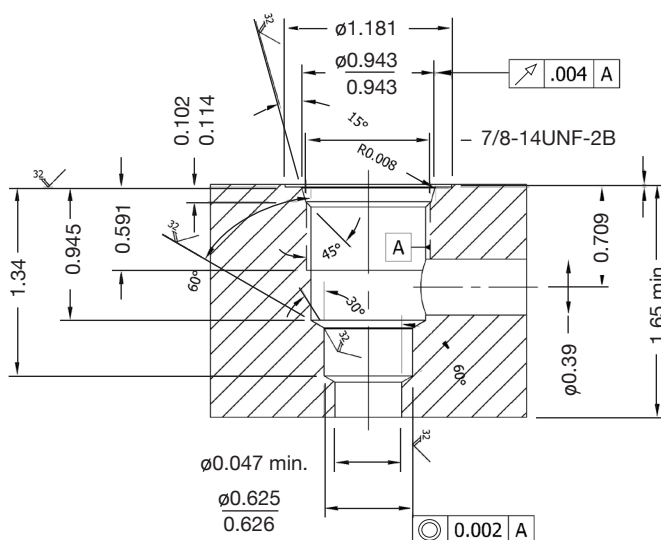
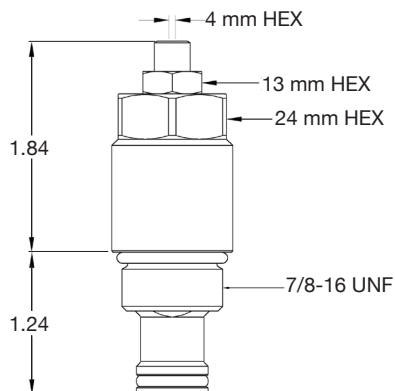

ORDERING INFORMATION

RVCP - S10 - N X - 2000

